

OWNER'S MANUAL

BassX-W10 AcoustaCell Wall Dampening System

The BassX-W10 AcoustaCell Wall Dampening System dramatically improves the performance of the BassX-W10 In-Wall Subwoofer by eliminating the acoustic problems caused by drywall. Installation can be easily done at the time you are ready to install the BassX-W10.

1. Remove any insulation materials from the wall cavity so that there will be room for the AcoustaCell System. Ideally, you should have 34½", centered top to bottom, clear for installation of AcoustaCell. With the area cleared of insulation, you are now ready to begin the installation.
2. Compress the lower AcoustaCell segment so that it is small enough to fit through the opening (See Figure 1) and place it down into the opening. Slowly move the AcoustaCell down until it measures 2" from the top of the AcoustaCell to the bottom edge of the cutout opening.
3. Compress the upper AcoustaCell segment and place it up into the opening (See Figure 1). Slowly move the AcoustaCell up until it measures 2" from the bottom of the AcoustaCell to the top edge of the cutout opening.
4. The last step is to place the center wall sheet into the wall cavity by removing the adhesive and placing it against the back wall, between the upper and lower AcoustaCell segments (See Figure 2).
NOTE: For 2x4 studs, do not use the center wall sheet, as BassX-W10 may not fit into wall cavity.
5. For best results, the speaker wire should be routed behind the AcoustaCell and should enter the AcoustaCell chamber just beneath the upper AcoustaCell segment from directly above or below the chamber (See Figure 3).
6. You are now ready for installation of your BassX-W10 in-wall subwoofer.

Figure 1

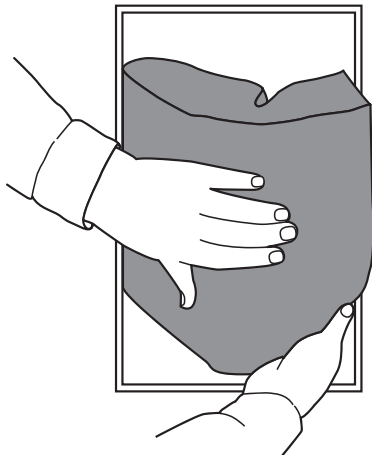

Figure 2

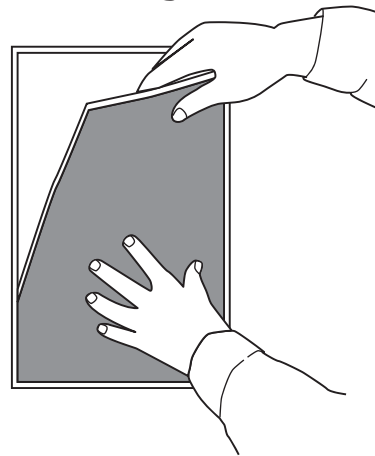
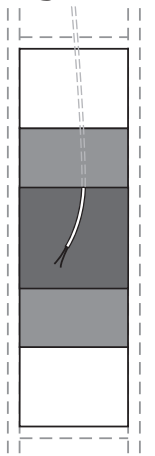

Figure 3



NOTE: In cases where the standard mounting configuration of AcoustaCell is not practical because of fireblocks or other obstructions, it may be mounted in any configuration that the wall space permits. This may include mounting both upper and lower segments above the center wall sheet or both of them below the center wall sheet. It may also include cutting the material down to fit into openings. To cut AcoustaCell, place it flat on a surface and place a straight edge along the line you wish to cut. Use a sharp utility knife to cut through the material. After cutting half-way through, turn it over and repeat the process from the other side.

SpeakerCraft offers a variety of accessories to make your installation of these speakers and other SpeakerCraft products easy, economical, and professional. Contact your authorized SpeakerCraft Dealer for more information.

For technical inquires, please call 1-800-448-0976 or e-mail us at techsupport@speakercraft.com. We are available to assist you every weekday, except holidays, between the hours of 7:00 a.m. and 5:00 p.m. PST.